



# Tug Zuliano XVI



## Principal Particulars

Flag	Venezuelan
Built	Singapore Slipway & Engineering Ltd. 1980
Crew	5 Persons.
Length OA	27.40 m
Length BP	24.50 m
Breadth Moulded	9.50 m
Depth Moulded	3.95 m
Designed Draft	3.75 m
Bollard Pull	36 tonnes
Designed Speed	13.5 Knots
<b>Electronics</b>	
Radar, main	Furuno Mark-2 1831 36 miles
VHF Radio	2 x Icom, Mod. IC-M45A
SSB Radio	Icom, Mod. IC-M700TY
Echo Sounder	JMC, Mod. V-7
GPS	Furuno, Mod. GP-30
Intercommunicator	Toa, Mod. A-506M
<b>Classification</b>	American Bureau of Shipping ABS 8007032 +A1 E + MS Towing Service

## Gross Tonnage Capacity

194.37 Tonnes  
Fuel - 70 tonnes  
Fresh Water - 37 Tonnes

## Machinery & Equipment

Main Engines	Two (2 sets diesels of Hedemora V12A 1350 BHP each at 1350 RPM
Propellers	Two (2) sets Schottel 506/505 in 360° steerable kort nozzles
Generators	Two (2) sets Detroit GM4-71 (N) 100KVA 440 V
Towing Hook	Mampaey SWL 50 Tonnes
Windlass	Daido Juki 3.5 Tonnes x 10 m/min.
Capstan	Yamamoto 3/1.5 tonnes x 10/20 m/min
Anti-Oil Pollution	Kashiwa portable system 250 L/min at 70 m head.
<b>O call sign</b>	9V5037



# Tug Zuliano XVI

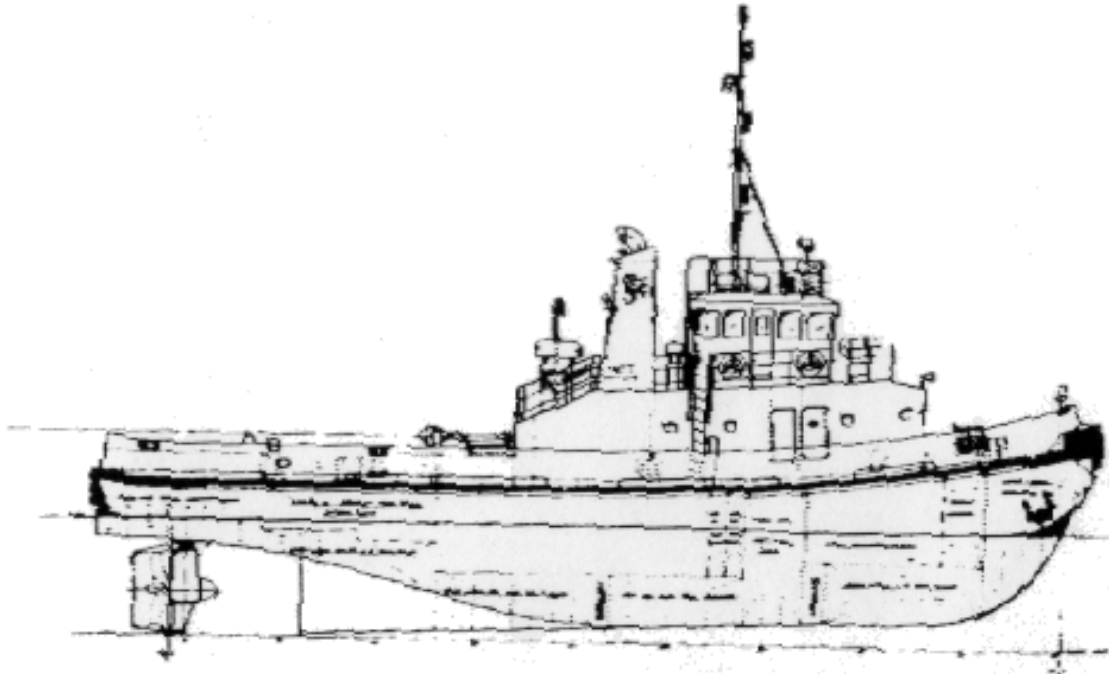

PROFILE

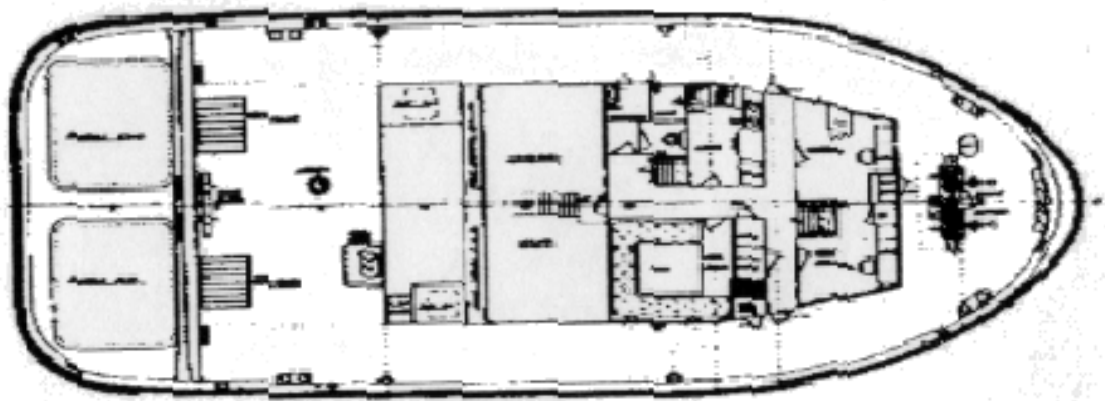

Main Deck

PLAN